

ELEVATION

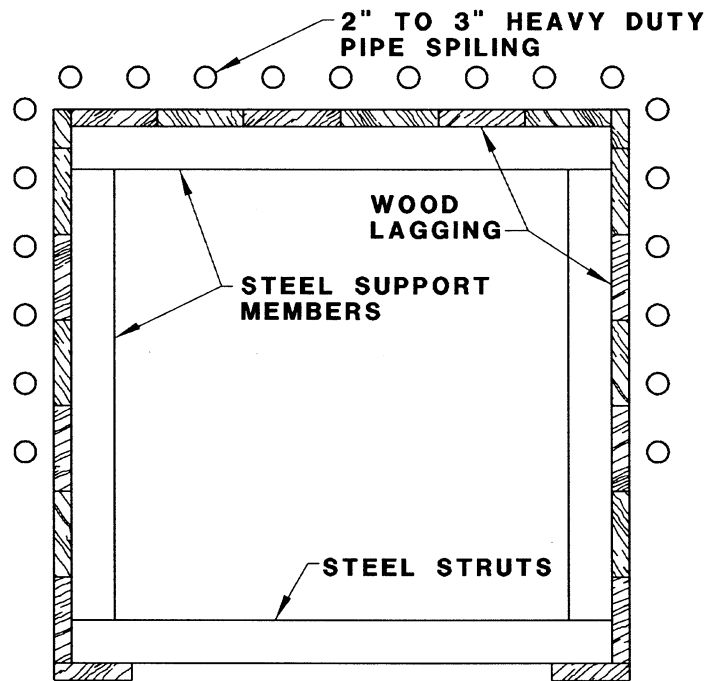

SECTION

Figure 5.20-7: Typical Tunnel Drift Construction

Figure 5.20-8
Estimated Construction Phasing for Transbay Terminal and Caltrain Downtown Extension

Activity	Estimated Duration in Months	CALENDAR YEAR											
		2003		2004		2005		2006		2007			
		mos.	mos.	mos.	mos.	mos.	mos.	mos.	mos.	mos.	mos.		
Relocate Utility Lines Along Track Corridor	12	1 - 6	7 - 12	13 - 18	19 - 24	25 - 30	31 - 36	37 - 42	43 - 48	49 - 54	55 - 60		
Demolish Buildings Along Track Corridor	12												
Construct Surface Rail Line & Station Improvements at San Francisco Yard	12												
Construct Retained-Cut Structure Along Track Corridor	12												
Construct Cut & Cover Subway Structure Along Track Corridor [b]	36												
Construct Temporary Bus Terminal and Access Ramps	9												
Demolish Existing Terminal and Construct New Terminal Building and Permanent Ramps	39												
Construct Permanent Off Site Bus Storage and Access Ramps	9												
Construct Track and Systems Facilities	18												
Reconstruct Streets	36												

[a] The schedule for both the Main and Mission Streets alternative alignments are the same. Overall schedule is same if tunneling alternative is used.

[b] Same duration for construction if tunneling is used as an alternative for part of this alignment.

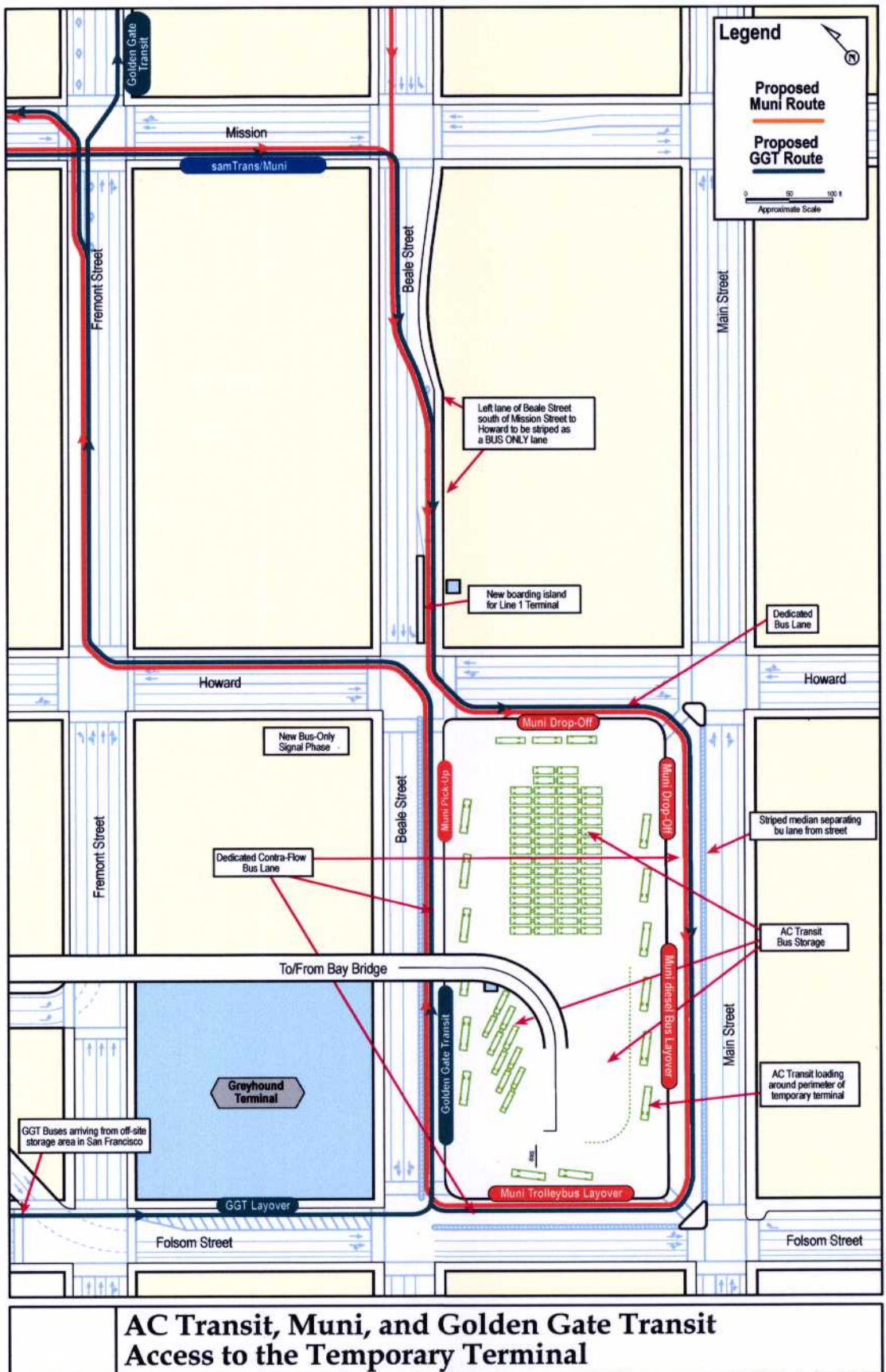

**AC Transit, Muni, and Golden Gate Transit
Access to the Temporary Terminal**

Figure 5.21-1